

















**NOTES:**

1. PHASE 1B CONSIST OF THE PROJECT AREA OF TAXIWAY UNIFORM EAST OF THE CARGO APRON. WORK IN THIS AREA WILL REQUIRE THE CLOSURE OF TAXIWAY UNIFORM NORTH OF TAXIWAY CHARLIE TO THE PHASE LIMITS.
2. PHASE 1B SHALL BE ACCESSED THROUGH GATE 23.
3. THE CONTRACTOR SHALL NOTIFY THE AIRPORT OPERATIONS AT LEAST 72 HOURS PRIOR TO ANY CONTINUOUS HAULING OPERATIONS.
4. WORK IN PHASE 1B SHALL BE COMPLETED WITHIN 7 CONSECUTIVE CALENDAR DAYS.
5. WORK IN PHASE 1B MAY BE PERFORMED CONCURRENTLY WITH WORK AREAS 1A AND 1C.
6. WORK IN PHASE 1B SHALL HAVE NO WORK HOUR RESTRICTIONS.
7. DURING PHASE 1B TAXIWAY BRAVO AND TAXIWAY UNIFORM NORTH OF THE PHASING LIMITS SHALL REMAIN OPEN TO AIRCRAFT TRAFFIC AT ALL TIMES.

**LEGEND**

-  PHASE 1B
-  HAUL ROUTE
-  TAXIWAY CLOSURE MARKER
-  FLAGMAN
-  LATH --- LATH LINE (25' SPACED)
-  ARFF ACCESS
-  LONG-TERM 0' BARRICADE SPACING FOR CONSTRUCTION PHASE OPERATIONS - RESTRICT ALL MOVEMENTS
-  4' BARRICADE SPACING FOR OPERATIONS - RESTRICT VEHICLE MOVEMENTS
-  8' BARRICADE SPACING FOR OPERATIONS - RESTRICT AIRCRAFT MOVEMENTS
-  EXISTING MARKING TO BE ERADICATED.
-  CRITICAL POINT (SEE SHEET G-5017)
-  SIGN VA-X OR CA (SEE SHEET G-5004 FOR DETAILS)

**KEY PLAN**

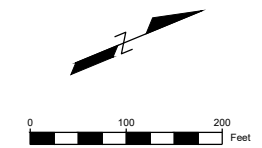
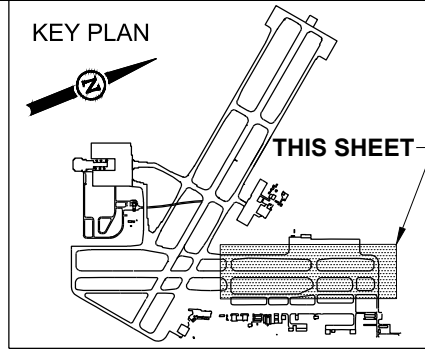

REVISION	DESCRIPTION	DATE	APPROVED

Approved by:	Project Date:
DESIGNED BY:	FILED 28, 2020
DRAWN BY:	FILED
CHECKED BY:	FILED
DATE:	FILED
PROJECT NO.:	FILED

**AIRPORT BOARD**  
**CITY OF SPRINGFIELD**  
**SPRINGFIELD-BRANSON NAT'L AP**  
**SPRINGFIELD, MISSOURI**

**AIP NO. 3-29-0077-057-2020**  
**TAXIWAY U RECONSTRUCTION**  
**CONSTRUCTION**  
**ACTIVITY PLAN - PHASE**  
**1B**

**IFB # 2020-SGF-02**  
**Sheet 18 of 107**  
**Drawing: G-5009**  
**VOL. 1 of 1**

**CONSTRUCTION**  
**ACTIVITY PLAN -**  
**PHASE 1B**

REV. 1 - ADDENDUM NO. 1  
 Sealed Digitally Mar. 19, 2020

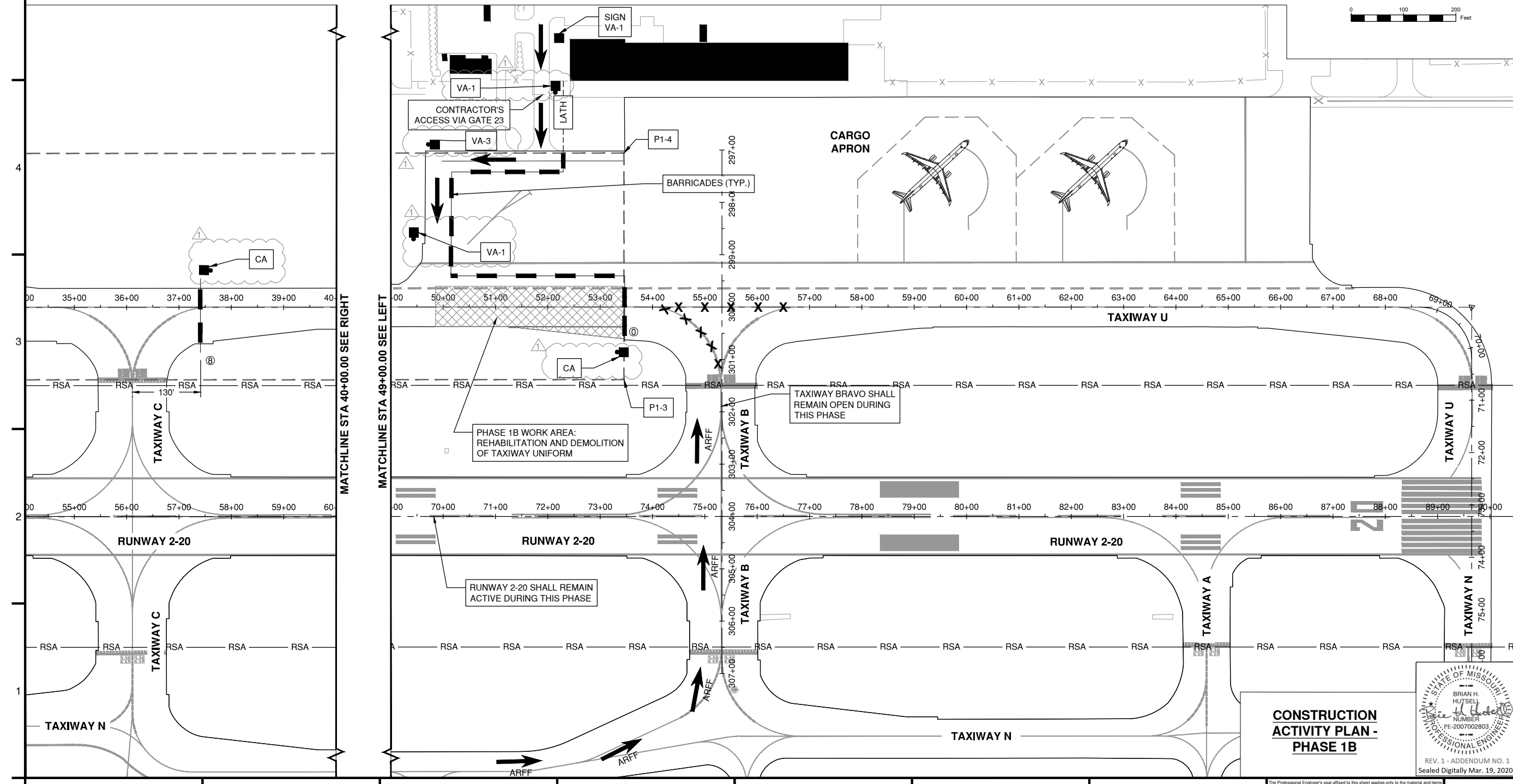

6  
5  
4  
3  
2  
1

MATCHLINE STA 40+00.00 SEE RIGHT

MATCHLINE STA 49+00.00 SEE LEFT

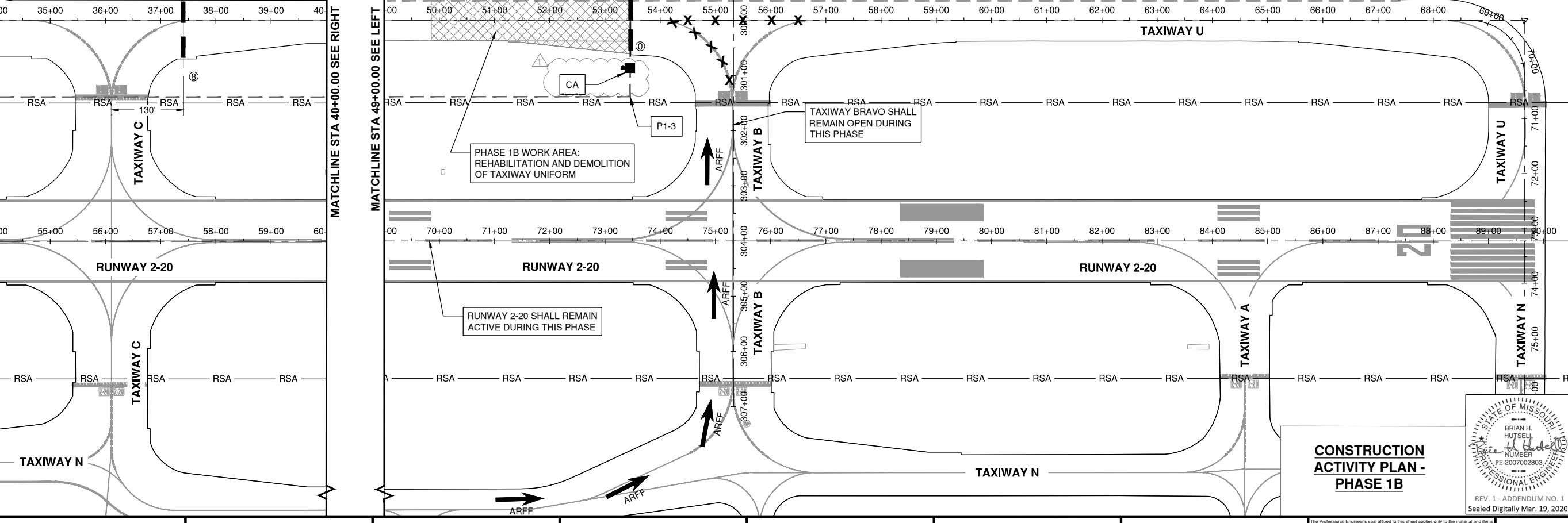















**NOTES:**

1. PHASE 1D DAY OPERATIONS CONSISTS OF THE PROJECT AREA OF TAXIWAY DELTA EAST AND WEST OF THE TAXIWAY DELTA AND TAXIWAY UNIFORM INTERSECTION. WORK IN THIS AREA WILL REQUIRE THE PARTIAL CLOSURE OF TAXIWAY DELTA AND TAXIWAY CHARLIE WEST OF RUNWAY 2-20.
2. PHASE 1D SHALL BE ACCESSED THROUGH GATE 23.
3. DURING PHASE 1D, RUNWAY 14-32 AND RUNWAY 2-20 WILL REMAIN OPEN AT ALL TIMES.
4. WORK IN PHASE 1D SHALL BE COMPLETED WITHIN 7 CONSECUTIVE CALENDAR DAYS.
5. WORK IN PHASE 1D DAY OPERATIONS MAY ONLY OCCUR CONCURRENTLY WITH PHASE 1D NIGHT OPERATIONS.
6. WORK IN PHASE 1D DAY OPERATIONS SHALL BE RESTRICTED TO NON-CONTINUOUS HAULING OPERATIONS ONLY.
7. PRIOR TO REOPENING TAXIWAY UNIFORM, DAYTIME BARRICADES SHALL BE PLACED ON THE EDGE OF PCC RECONSTRUCTION AREA AND SHALL BE APPROVED BY AIRPORT OPERATIONS. THE CONTRACTOR SHALL THOROUGHLY SWEEP AND CLEAN AIRFIELD PAVEMENT BEFORE REOPENING TAXIWAY DELTA. TAXIWAY DELTA 75' WIDTH SHALL BE MAINTAINED AT ALL TIMES DURING DAYTIME OPERATIONS.
8. OPEN TRENCHES OR EXCAVATIONS ARE NOT PERMITTED WITHIN THE TAXIWAY SAFETY AREA WHILE THE TAXIWAY IS OPEN FOR UNRESTRICTED AIRCRAFT OPERATIONS. TRENCHES SHOULD BE BACKFILLED BEFORE THE TAXIWAY IS OPENED. IF THE BACKFILLING EXCAVATIONS TO ALLOW THE SAFE PASSAGE OF ARFF EQUIPMENT AND OF THE HEAVIEST AIRCRAFT OPERATING ON THE TAXIWAY ACROSS THE TRENCH WITHOUT CAUSING DAMAGE TO THE EQUIPMENT OR AIRCRAFT. IN RARE CIRCUMSTANCES WHERE THE SECTION OF TAXIWAY IS INDISPENSABLE FOR AIRCRAFT MOVEMENT, OPEN TRENCHES OR EXCAVATIONS MAY BE PERMITTED IN THE TAXIWAY SAFETY AREA WHILE THE TAXIWAY IS OPEN TO AIRCRAFT OPERATIONS, SUBJECT TO THE FOLLOWING RESTRICTIONS: TAXIING SPEED IS LIMITED TO 10 MPH, APPROPRIATE NOTAMS ARE ISSUED, LOW MASS, LOW-PROFILE LIGHTED BARRICADES ARE INSTALLED AND APPROPRIATE TEMPORARY ORANGE CONSTRUCTION SIGNS ARE INSTALLED.

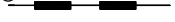
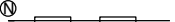
**LEGEND**

-  PHASE 1D DAY OPERATIONS (PCC PANEL RECONSTRUCTION)
-  HAUL ROUTE
-  TAXIWAY CLOSURE MARKER
-  FLAGMAN
-  LIGHTED RUNWAY CLOSURE
-  LATH LINE (25' SPACED)
-  SIGN VA-X OR CA (SEE SHEET G-5004 FOR DETAILS)
-  LONG-TERM 0' BARRICADE SPACING FOR CONSTRUCTION PHASE OPERATIONS - RESTRICT ALL MOVEMENTS
-  4' BARRICADE SPACING FOR OPERATIONS - RESTRICT VEHICLE MOVEMENTS
-  8' BARRICADE SPACING FOR OPERATIONS - RESTRICT AIRCRAFT MOVEMENTS
-  BARRICADES TO BE PLACED DURING NIGHTTIME OPERATIONS ONLY AT 8' SPACING
-  BARRICADES TO BE PLACED DURING DAYTIME OPERATIONS ONLY AT 8'
-  CRITICAL POINT. (SEE SHEET G-5017)

**KEY PLAN**

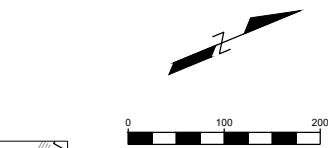
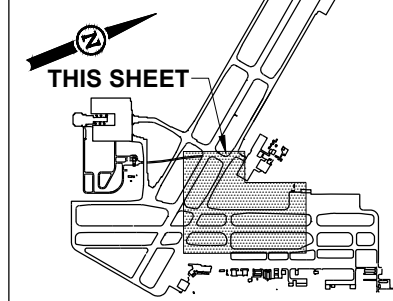

MATCHLINE SEE TO THE RIGHT

MATCHLINE SEE TO THE LEFT

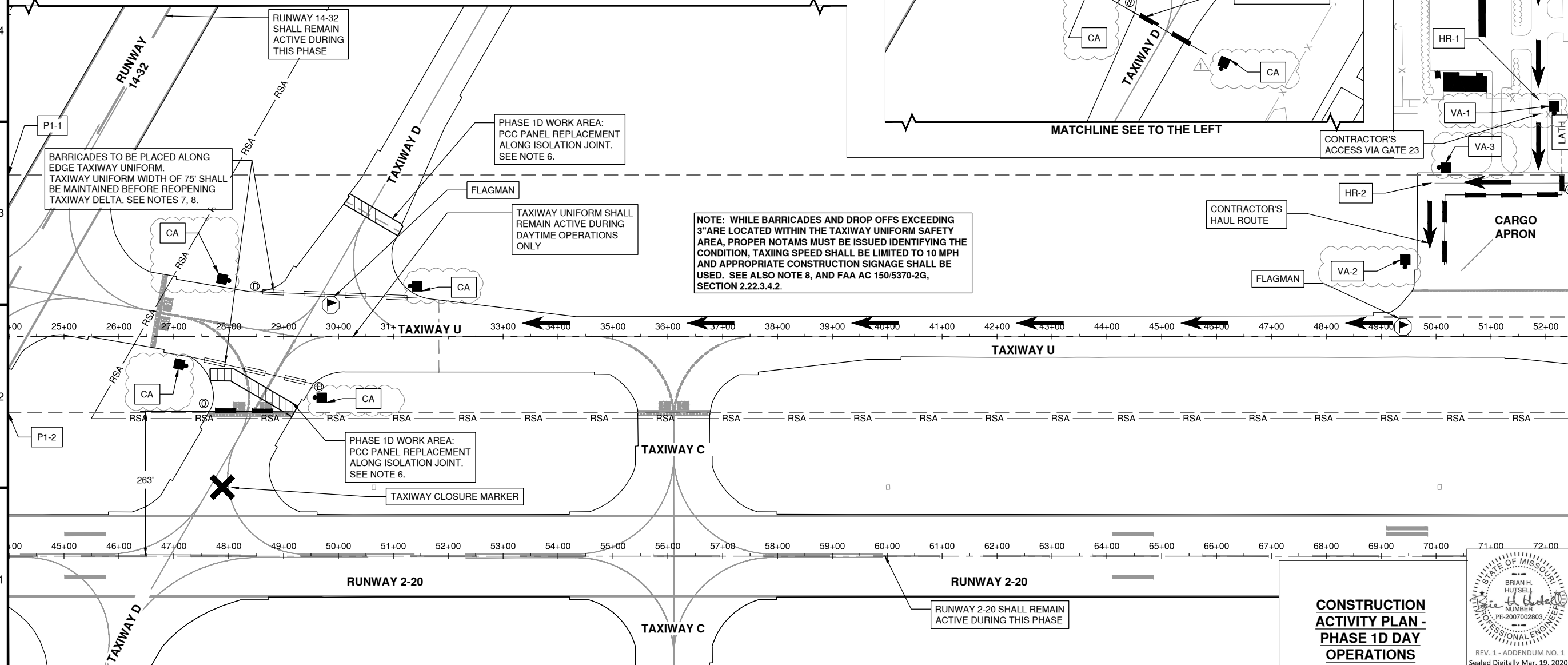

**NOTE: WHILE BARRICADES AND DROP OFFS EXCEEDING 3" ARE LOCATED WITHIN THE TAXIWAY UNIFORM SAFETY AREA, PROPER NOTAMS MUST BE ISSUED IDENTIFYING THE CONDITION, TAXIING SPEED SHALL BE LIMITED TO 10 MPH AND APPROPRIATE CONSTRUCTION SIGNAGE SHALL BE USED. SEE ALSO NOTE 8, AND FAA AC 150/5370-2G, SECTION 2.22.3.4.2.**

**CONSTRUCTION  
ACTIVITY PLAN -  
PHASE 1D DAY  
OPERATIONS**

REV. 1 - ADDENDUM NO. 1  
Sealed Digitally Mar. 19, 2020



REVISION	DESCRIPTION	DATE	APPROVED

Approved by:	Project Date:
DESIGNED BY:	FILED:
DRAWN BY:	DATE:
CHECKED BY:	TIME:
DATE:	SCALE:
PROJECT NO.:	PROJECT NAME:

**CITY OF SPRINGFIELD**  
**SPRINGFIELD-BRANSON NAT'L AP**  
**SPRINGFIELD, MISSOURI**

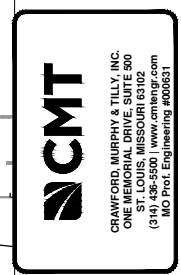

**AIP NO. 3-29-0077-057-2020**  
**TAXIWAY U RECONSTRUCTION**  
**CONSTRUCTION PLAN - PHASE 1D DAY OPERATIONS**

IFB # 2020-SGF-02  
 Sheet 20 of 107  
 Drawing: G-5011  
 VOL. 1 of 1









The Professional Engineer's seal affixed to this sheet applies only to the material and forms shown on this sheet. All drawings, instruments or other documents not exhibiting this seal shall not be considered prepared by this engineer, and this engineer expressly disclaims any and all responsibility for such plan, drawings or documents not exhibiting this seal.



**NOTES:**

1. PHASE 2A CONSISTS OF THE PROJECT AREA OUTSIDE OF THE HOLD LINE OF RUNWAY 2-20. WORK IN THIS AREA WILL REQUIRE THE PARTIAL CLOSURE OF TAXIWAY UNIFORM.
2. PHASE 2A SHALL BE ACCESSED THROUGH GATE 20 FOR GENERAL USE. FOR CONTINUOUS HAULING (AGGREGATE, RECYCLED CONCRETE, CONCRETE HAULING/DELIVERY, ETC.), THE TEMPORARY CONSTRUCTION ACCESS GATE SHALL BE UTILIZED.
3. THE CONTRACTOR SHALL PROVIDE A BADGED GATE SECURITY GUARD AT THE TEMPORARY CONSTRUCTION ACCESS GATE DURING CONTINUOUS HAULING OPERATIONS TO PREVENT UNAUTHORIZED ENTRY.
4. WORK IN PHASE 2A MAY BE PERFORMED CONCURRENTLY WITH WORK AREA 2B.
5. WORK IN PHASE 2A SHALL HAVE NO WORK HOUR RESTRICTIONS.
6. DURING THE WORK IN PHASE 2A, THE CARGO APRON, TAXIWAY BRAVO AND TAXIWAY UNIFORM WILL REMAIN OPEN TO AIRCRAFT TRAFFIC SOUTH OF THE PROJECT AREA.

**LEGEND**

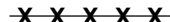
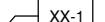
-  PHASE 2A
-  HAUL ROUTE
-  TAXIWAY CLOSURE MARKER
-  FLAGMAN
-  SIGN VA-X OR CA (SEE SHEET G-5004 FOR DETAILS)
-  LONG-TERM 0' BARRICADE SPACING FOR CONSTRUCTION PHASE OPERATIONS - RESTRICT ALL MOVEMENTS
-  4' BARRICADE SPACING FOR OPERATIONS - RESTRICT VEHICLE MOVEMENTS
-  8' BARRICADE SPACING FOR OPERATIONS - RESTRICT AIRCRAFT MOVEMENTS
-  EXISTING MARKING TO BE ERADICATED.
-  CRITICAL POINT (SEE SHEET G-5017)

**KEY PLAN**

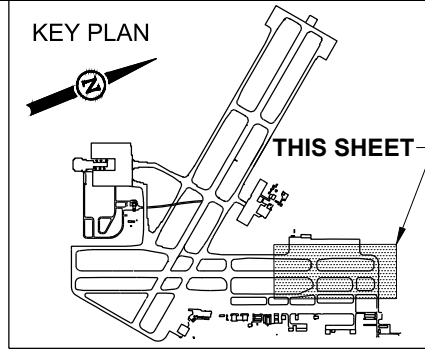

REVISION	DESCRIPTION	DATE	APPROVED

Approved by:	Project Date:
DES: TCS	FEB 28, 2020
DWG BY: DPH	Proj. Scale:
CHK BY: BHH	
Plot Date:	19-Mar-20 14:17
Plot By:	Brian Huffsell
Page Size:	A1 Full Size Sheet 22"x34"
File Name:	G_5000_PHASE2A_PLANS.DWG
Autofill Project No.:	
CMT Project No.:	18-032-0025-01

AIRPORT BOARD  
**CITY OF SPRINGFIELD**  
 SPRINGFIELD-BRANSON NAT'L AP  
 SPRINGFIELD, MISSOURI



AIP NO. 3-29-0077-057-2020  
 TAXIWAY U RECONSTRUCTION  
**CONSTRUCTION ACTIVITY PLAN - PHASE 2A**

IFB # 2020-SGF-02  
 Sheet 22 of 107  
 Drawing: G-5013  
 VOL. 1 of 1

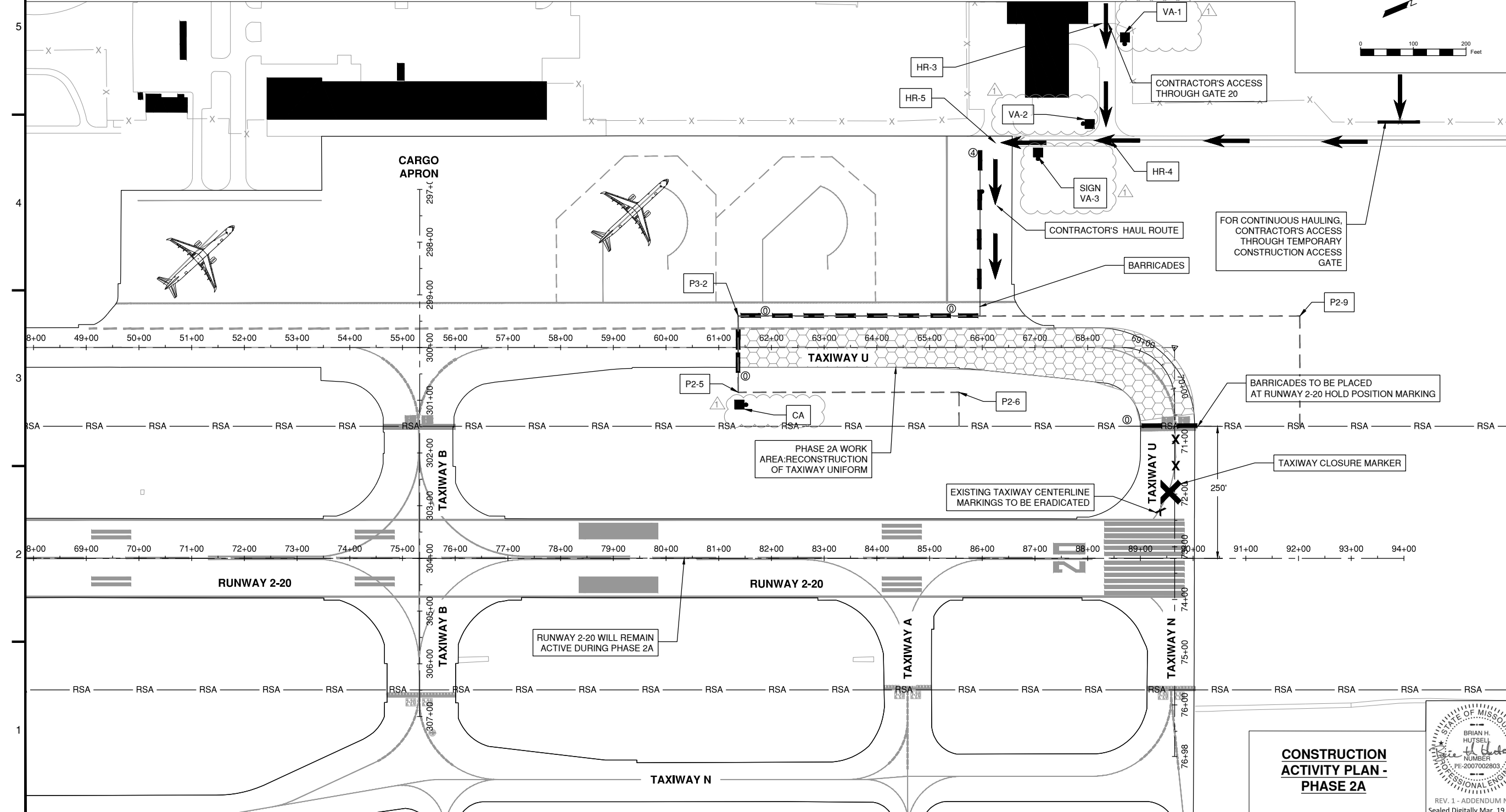

**CONSTRUCTION ACTIVITY PLAN - PHASE 2A**

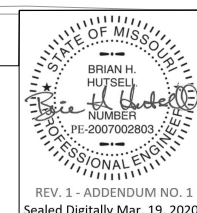

The Professional Engineer's seal affixed to this sheet applies only to the material and items shown on this sheet. All drawings, instruments or other documents not exhibiting this seal shall not be considered prepared by this engineer, and this engineer expressly disclaims any and all responsibility for such plan, drawings or documents not exhibiting this seal.

**NOTES:**

1. PHASE 2B CONSISTS OF THE PROJECT AREA INSIDE OF THE HOLD LINE OF RUNWAY 2-20. WORK IN THIS AREA WILL REQUIRE THE PARTIAL CLOSURE OF TAXIWAYS UNIFORM, ALPHA AND NOVEMBER ALONG WITH FULL CLOSURE OF RUNWAY 2-20.
2. DURING PHASE 2B, RUNWAY 2-20 WILL BE CLOSED AS SHOWN. RUNWAY LIGHTED CLOSURE MARKERS ARE REQUIRED DURING PHASE 2B.
3. PHASE 2B SHALL BE ACCESSED THROUGH GATE 20 FOR GENERAL USE. FOR CONTINUOUS HAULING (AGGREGATE, RECYCLED CONCRETE, CONCRETE HAULING/DELIVERY, ETC.), THE TEMPORARY CONSTRUCTION ACCESS GATE SHALL BE UTILIZED.
4. THE CONTRACTOR SHALL PROVIDE A BADGED GATE SECURITY GUARD AT THE TEMPORARY CONSTRUCTION ACCESS GATE DURING CONTINUOUS HAULING OPERATIONS TO PREVENT UNAUTHORIZED ENTRY.
5. THE CONTRACTOR SHALL NOTIFY THE AIRPORT OPERATIONS AT LEAST 72 HOURS PRIOR TO ANY IMPLEMENTATION OF PHASE 2B.
6. WORK IN PHASE 2B SHALL BE COMPLETED DURING RUNWAY 2-20 45 - DAY CLOSURE.
7. WORK IN PHASE 2B MAY BE PERFORMED CONCURRENTLY WITH WORK AREA 2A.
8. DURING PHASE 2B, TAXIWAY BRAVO, THE CARGO APRON AND TAXIWAY UNIFORM SHALL BE OPEN TO AIRCRAFT TRAFFIC SOUTH OF THE PROJECT AREA.
9. TAXIWAY U ELECTRICAL REHABILITATION AT TAXIWAY CHARLIE AND TAXIWAY DELTA SHALL NOT OCCUR CONCURRENTLY. SEE SHEETS E-1101 AND E-1102 FOR ELECTRICAL

**REPLACEMENT LOCATIONS.**

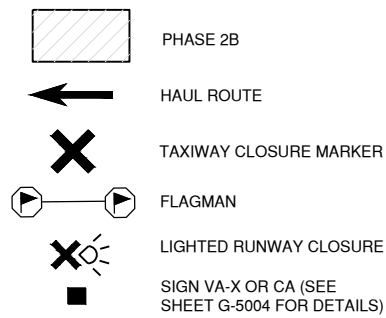

**LEGEND**

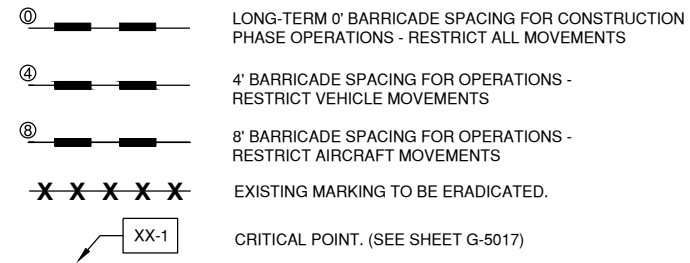

**KEY PLAN**

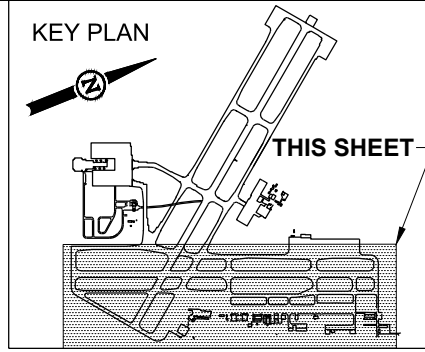

REVISION	DESCRIPTION	DATE	APPROVED

Approved by:	Project Date:
DESIGNED BY:	19 MAR 20 14:17
DRAWN BY:	19 MAR 20 14:17
CHECKED BY:	19 MAR 20 14:17
DATE:	19 MAR 20 14:17
PROJECT NO.:	18-032-002-01

**AIRPORT BOARD**  
**CITY OF SPRINGFIELD**  
**SPRINGFIELD-BRANSON NAT'L AP**  
**SPRINGFIELD, MISSOURI**



**CONSTRUCTION ACTIVITY PLAN - PHASE 2B**  
 AIP NO. 3-29-0077-057-2020  
 TAXIWAY U RECONSTRUCTION

IFB # 2020-SGF-02  
 Sheet 23 of 107  
 Drawing: G-5014  
 VOL. 1 of 1

**RUNWAY 2-20 REHABILITATION AREA**

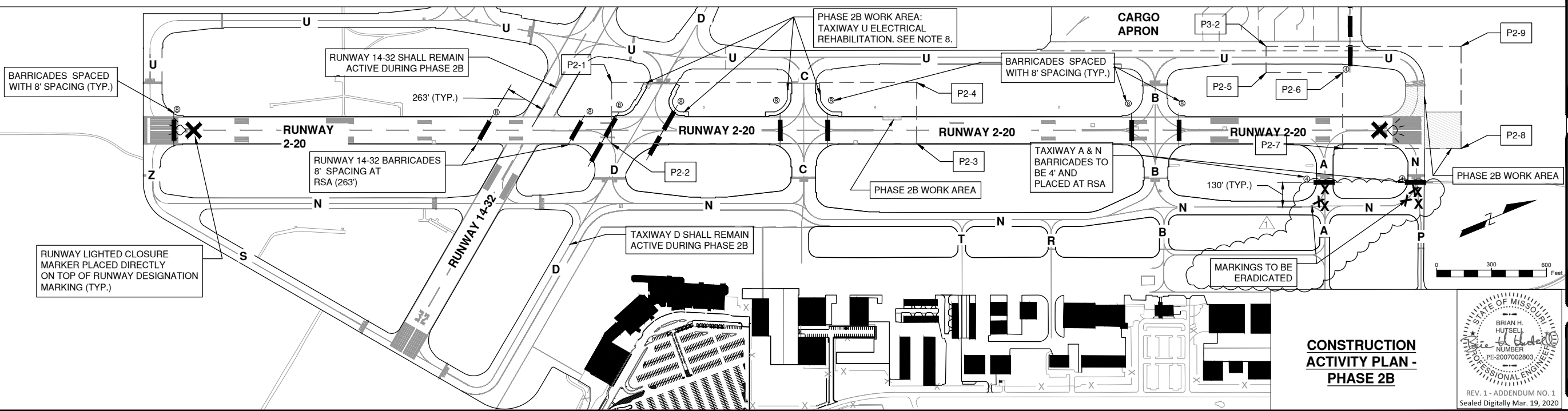
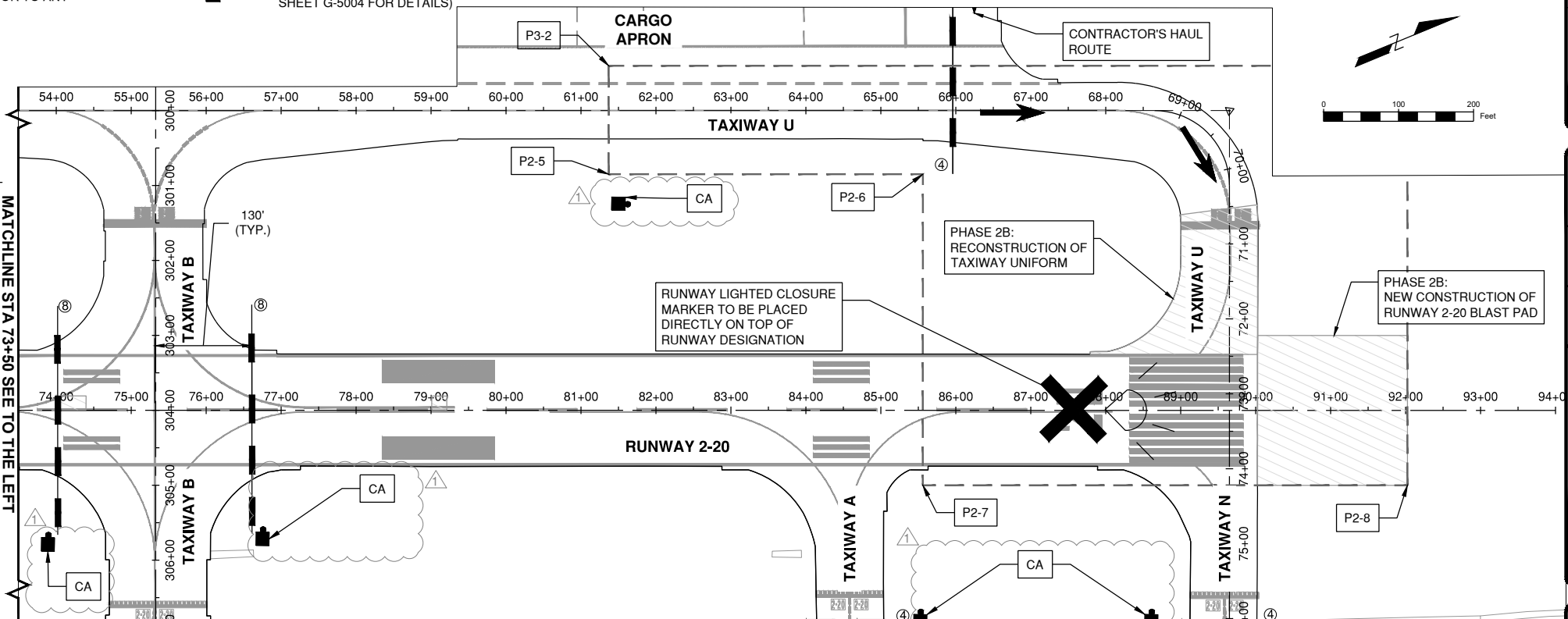
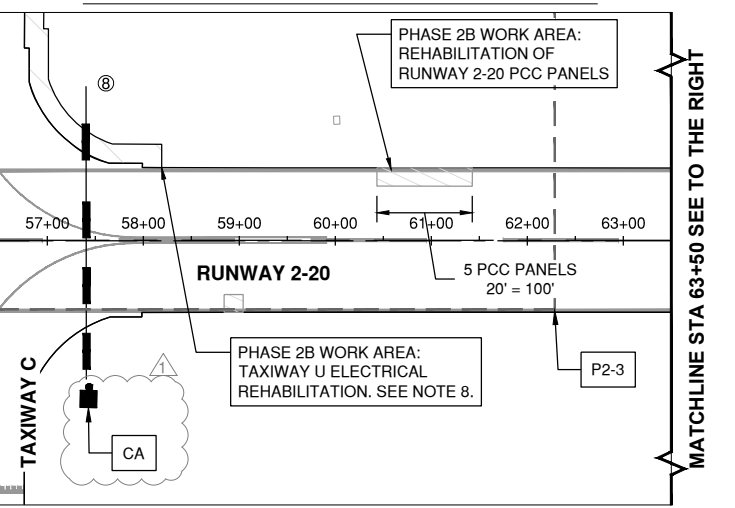

**CONSTRUCTION ACTIVITY PLAN - PHASE 2B**

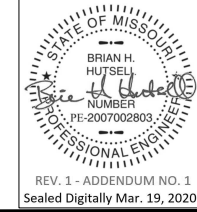

REV. 1 - ADDENDUM NO. 1  
 Sealed Digitally Mar. 19, 2020









The Professional Engineer's seal affixed to this sheet applies only to the material and items shown on this sheet. All drawings, instruments or other documents not exhibiting this seal shall not be considered prepared by this engineer, and the engineer expressly disclaims any and all responsibility for such plan, drawings or documents not exhibiting this seal.



**NOTES:**

- PHASE 3A CONSISTS OF THE DEMOLITION OF TAXIWAY BRAVO INSIDE OF THE HOLD LINE OF RUNWAY 2-20. WORK IN THIS AREA WILL REQUIRE THE FULL CLOSURE OF TAXIWAY BRAVO AND RUNWAY 2-20.
- PHASE 3A SHALL BE ACCESSED THROUGH GATE 23.
- THE CONTRACTOR SHALL PROVIDE A BADGED GATE SECURITY GUARD AT GATE 23 DURING CONTINUOUS HAULING OPERATIONS (AGGREGATE, RECYCLED CONCRETE, CONCRETE HAULING/DELIVERY, ETC.) TO PREVENT UNAUTHORIZED ENTRY.
- RUNWAY LIGHTED CLOSURE MARKER WILL BE REQUIRED DURING PHASE 3A.
- WORK IN PHASE 3A SHALL BE COMPLETED DURING RUNWAY 2-20 7 DAY CLOSURE.
- WORK IN PHASE 3A MAY BE PERFORMED CONCURRENTLY WITH WORK AREA 3B.
- WORK IN PHASE 3A SHALL HAVE NO WORK HOUR RESTRICTIONS.
- WORK IN PHASE 3A MUST FOLLOW PHASE 2B, RUNWAY 2-20 45-DAY CLOSURE.
- WORK IN PHASE 3A MAY NOT BE PERFORMED UNTIL THE COMPLETION OF PHASE 2B AND REOPENING OF TAXIWAY UNIFORM.

**LEGEND**

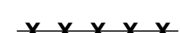
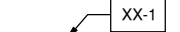
-  PHASE 3A
-  HAUL ROUTE
-  FLAGMAN
-  LIGHTED RUNWAY CLOSURE
-  SIGN VA-X OR CA (SEE SHEET G-5004 FOR DETAILS)
-  LONG-TERM 0' BARRICADE SPACING FOR CONSTRUCTION PHASE OPERATIONS - RESTRICT ALL MOVEMENTS
-  4' BARRICADE SPACING FOR OPERATIONS - RESTRICT VEHICLE MOVEMENTS
-  8' BARRICADE SPACING FOR OPERATIONS - RESTRICT AIRCRAFT MOVEMENTS
-  EXISTING MARKING TO BE ERADICATED.
-  CRITICAL POINT. (SEE SHEET G-5017)

**KEY PLAN**

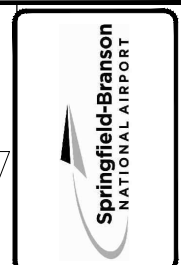
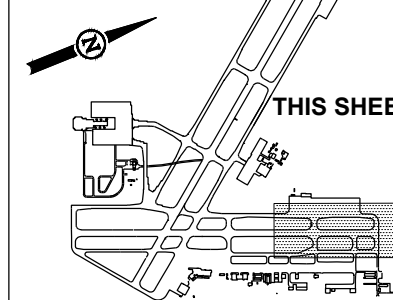

REVISION	DESCRIPTION	DATE	APPROVED

Designed by:	TCN	CHK BY:	BHH
Drawn by:	DPH	Plot Date:	19-Mar-20 14:18
Checked by:	BHH	Plot By:	Brian Huttsell
Project No.:	18-032-002-01	File Name:	G_5000_PHASE3A_PLANS.DWG

AIRPORT BOARD  
**CITY OF SPRINGFIELD**  
 SPRINGFIELD-BRANSON NAT'L AP  
 SPRINGFIELD, MISSOURI

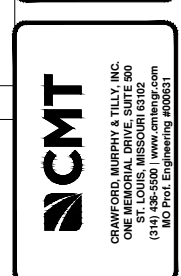

AIP NO. 3-29-0077-057-2020  
 TAXIWAY U RECONSTRUCTION  
**CONSTRUCTION ACTIVITY PLAN - PHASE 3A**

IFB # 2020-SGF-02  
 Sheet 24 of 107  
 Drawing: G-5015  
 VOL. 1 of 1

**CONSTRUCTION ACTIVITY PLAN - PHASE 3A**

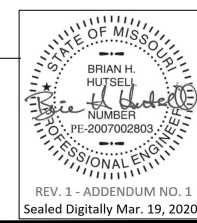

REV. 1 - ADDENDUM NO. 1  
 Sealed Digitally Mar. 19, 2020

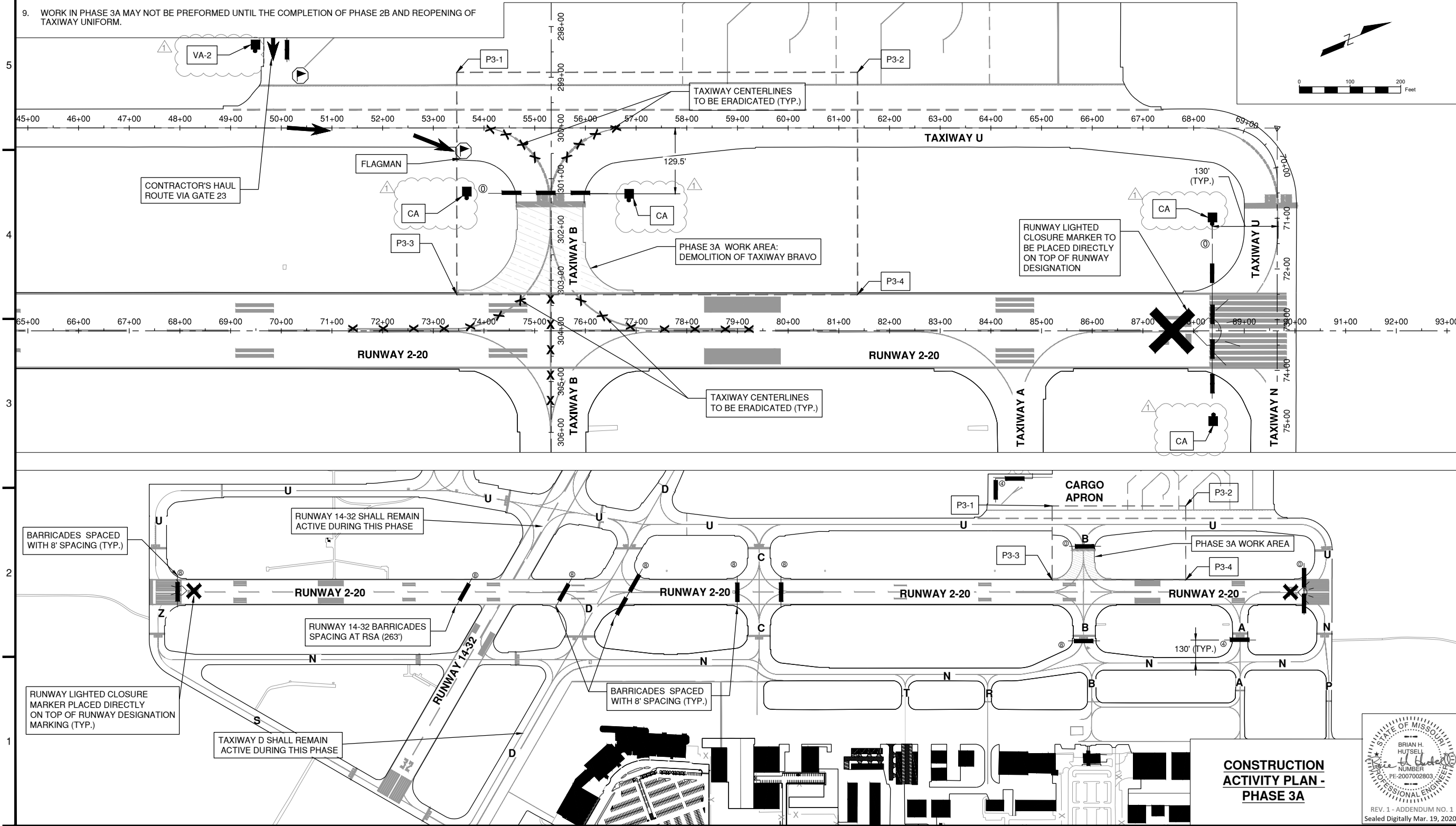









The Professional Engineer's seal affixed to this sheet applies only to the material and items shown on this sheet. All drawings, instruments or other documents not exhibiting this seal shall not be considered prepared by this engineer, and this engineer expressly disclaims any and all responsibility for such plan, drawings or documents not exhibiting this seal.

**NOTES:**

1. PHASE 3B CONSISTS OF THE PROJECT AREA OF TAXIWAY UNIFORM OUTSIDE OF THE CARGO APRON AND TAXIWAY BRAVO WEST OF THE RUNWAY HOLD LINE. WORK IN THIS PHASE WILL REQUIRE THE PARTIAL CLOSURE OF TAXIWAYS UNIFORM AND BRAVO.
2. PHASE 3B SHALL BE ACCESSED THROUGH GATE 23.
3. THE CONTRACTOR SHALL PROVIDE A BADGED GATE SECURITY GUARD AT GATE 23 DURING CONTINUOUS HAULING OPERATIONS (AGGREGATE, RECYCLED CONCRETE, CONCRETE HAULING/DELIVERY, ETC.) TO PREVENT UNAUTHORIZED ENTRY.
4. WORK IN PHASE 3B MAY BE PERFORMED CONCURRENTLY WITH WORK AREA 3A.
5. WORK IN PHASE 3B SHALL HAVE NO WORK HOUR RESTRICTIONS.
6. DURING PHASE 3B, TAXIWAY UNIFORM SHALL BE OPEN TO AIRCRAFT TRAFFIC SOUTH OF THE PROJECT AREA. TAXIWAY UNIFORM ACCESS VIA RUNWAY 20 END WILL ONLY ALLOW CARGO APRON ACCESS.

**LEGEND**

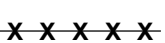
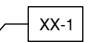
-  PHASE 3B
-  HAUL ROUTE
-  TAXIWAY CLOSURE MARKER
-  LATH --- LATH LINE (25' SPACED)
-  SIGN VA-X OR CA (SEE SHEET G-5004 FOR DETAILS)
-  LONG-TERM 0' BARRICADE SPACING FOR CONSTRUCTION PHASE OPERATIONS - RESTRICT ALL MOVEMENTS
-  4' BARRICADE SPACING FOR OPERATIONS - RESTRICT VEHICLE MOVEMENTS
-  8' BARRICADE SPACING FOR OPERATIONS - RESTRICT AIRCRAFT MOVEMENTS
-  EXISTING MARKING TO BE ERADICATED.
-  CRITICAL POINT. (SEE SHEET G-5017)

**KEY PLAN**

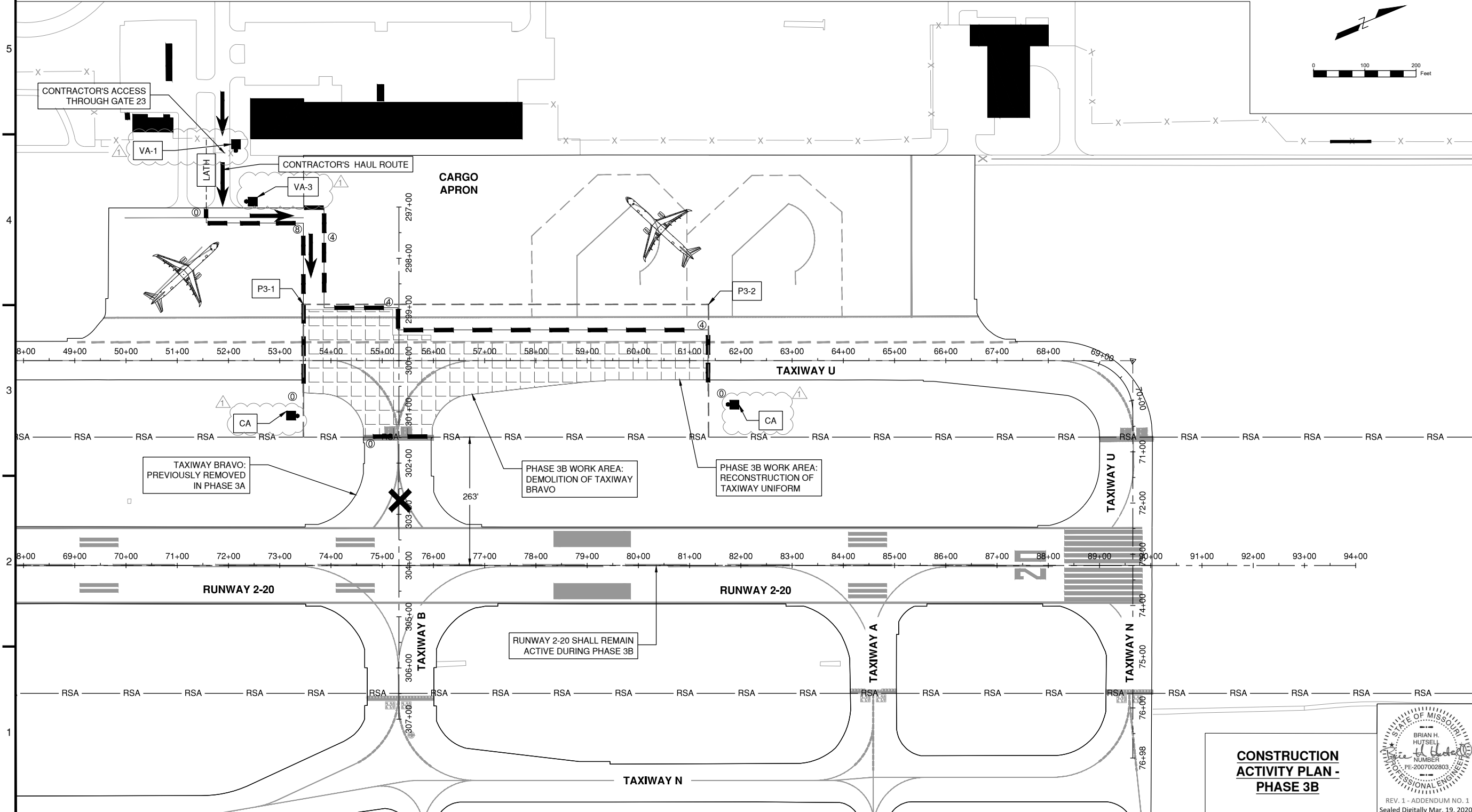
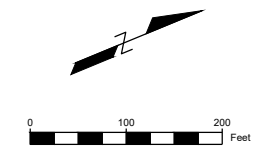
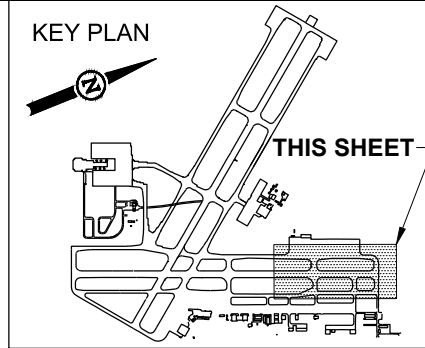

REVISION	DESCRIPTION	DATE	APPROVED

Approved by:	Project Date:
DESIGNED BY: TCS	18 FEB 28, 2020
DRAWN BY: BHH	Plot Scale:
DATE: 19 MAR 20 14:18	Plot By: Brian Hufsel
Page Size: A1 Full Size Sheet 22"x34"	File Name: G_5000_PHASE3B_PLANS.DWG
Artid Project No.:	CMT Project No.:
	18-002-0025-01

AIRPORT BOARD  
**CITY OF SPRINGFIELD**  
 SPRINGFIELD-BRANSON NAT'L AP  
 SPRINGFIELD, MISSOURI



AIP NO. 3-29-0077-057-2020  
 TAXIWAY U RECONSTRUCTION  
**CONSTRUCTION ACTIVITY PLAN - PHASE 3B**

IFB # 2020-SGF-02  
 Sheet 25 of 107  
 Drawing: G-5016  
 VOL. 1 of 1

**CONSTRUCTION ACTIVITY PLAN - PHASE 3B**

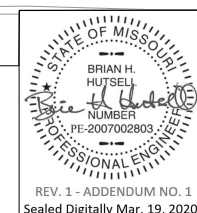

REV. 1 - ADDENDUM NO. 1  
 Sealed Digitally Mar. 19, 2020

The Professional Engineer's seal affixed to this sheet applies only to the material and items shown on this sheet. All drawings, instruments or other documents not exhibiting this seal shall not be considered prepared by this engineer, and this engineer expressly disclaims any and all responsibility for such plan, drawings or documents not exhibiting this seal.

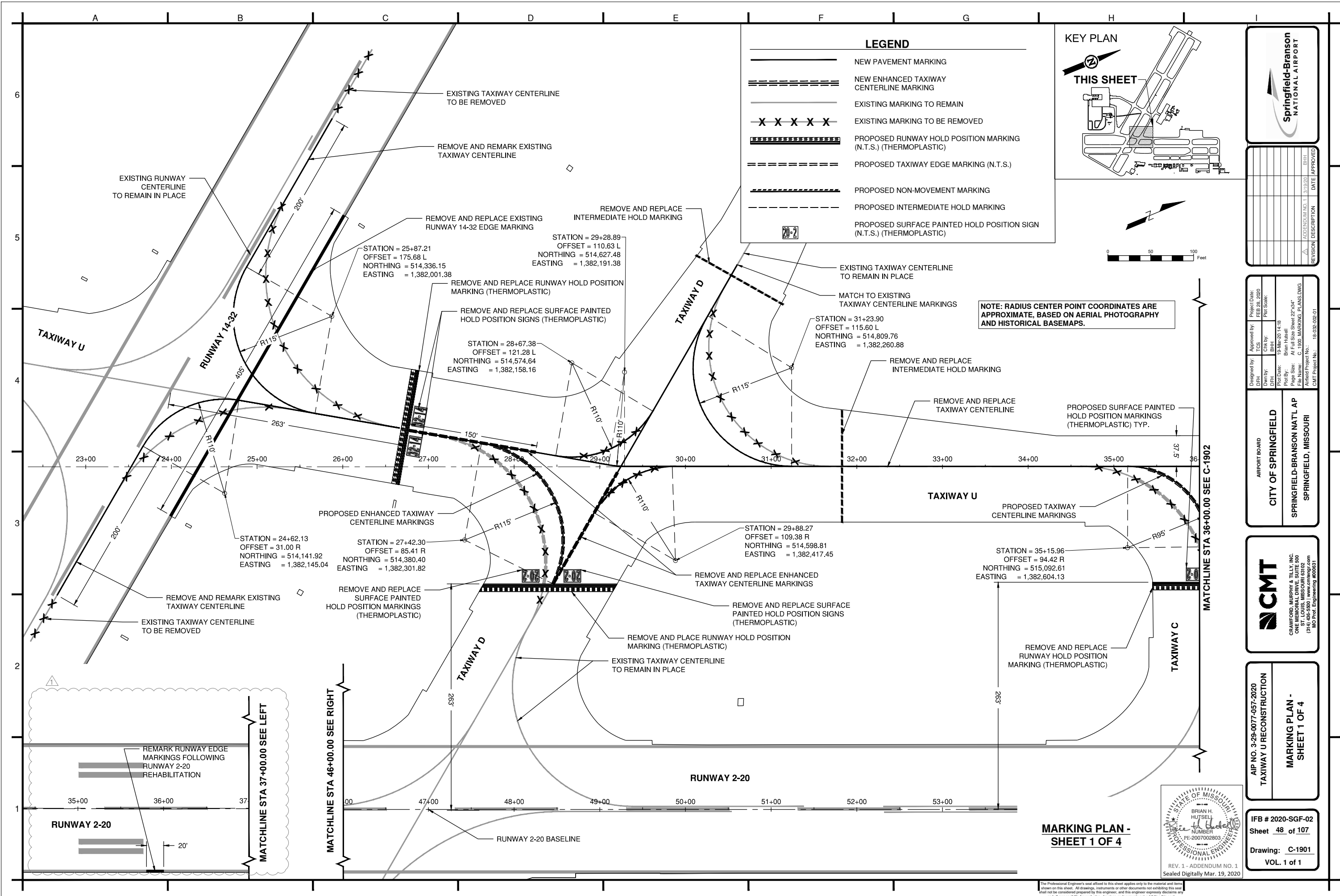

### LEGEND

- NEW PAVEMENT MARKING
- NEW ENHANCED TAXIWAY CENTERLINE MARKING
- EXISTING MARKING TO REMAIN
- EXISTING MARKING TO BE REMOVED
- PROPOSED RUNWAY HOLD POSITION MARKING (N.T.S.) (THERMOPLASTIC)
- PROPOSED TAXIWAY EDGE MARKING (N.T.S.)
- PROPOSED NON-MOVEMENT MARKING
- PROPOSED INTERMEDIATE HOLD MARKING
- PROPOSED SURFACE PAINTED HOLD POSITION SIGN (N.T.S.) (THERMOPLASTIC)

### KEY PLAN

THIS SHEET

0 50 100 Feet

Springfield-Branson NATIONAL AIRPORT	
ADDENDUM NO. 1	DATE APPROVED
REVISION	DESCRIPTION

NOTE: RADIUS CENTER POINT COORDINATES ARE APPROXIMATE, BASED ON AERIAL PHOTOGRAPHY AND HISTORICAL BASEMAPS.

Project Date:	FEB 28, 2020
Approved by:	TCS
Drawn by:	DH
Checked by:	CS
Scale:	AS SHOWN
File Name:	C:\1900_MARKING_PLANS.DWG
Project No.:	18-032-002-01

AIRPORT BOARD  
**CITY OF SPRINGFIELD**  
 SPRINGFIELD-BRANSON NAT'L AP  
 SPRINGFIELD, MISSOURI

**CMT**  
 CRAWFORD, MURPHY & TILLY, INC.  
 ONE MEMORIAL DRIVE, SUITE 500  
 SPRINGFIELD, MISSOURI 65801  
 (417) 864-5800 | www.cmtinc.com  
 MO Prof. Engineering #006831

AIP NO. 3-29-0077-057-2020  
 TAXIWAY U RECONSTRUCTION  
**MARKING PLAN -**  
**SHEET 1 OF 4**

IFB # 2020-SGF-02  
 Sheet 48 of 107  
 Drawing: C-1901  
 VOL. 1 of 1

REV. 1 - ADDENDUM NO. 1  
 Sealed Digitally Mar. 19, 2020

**MARKING PLAN -**  
**SHEET 1 OF 4**

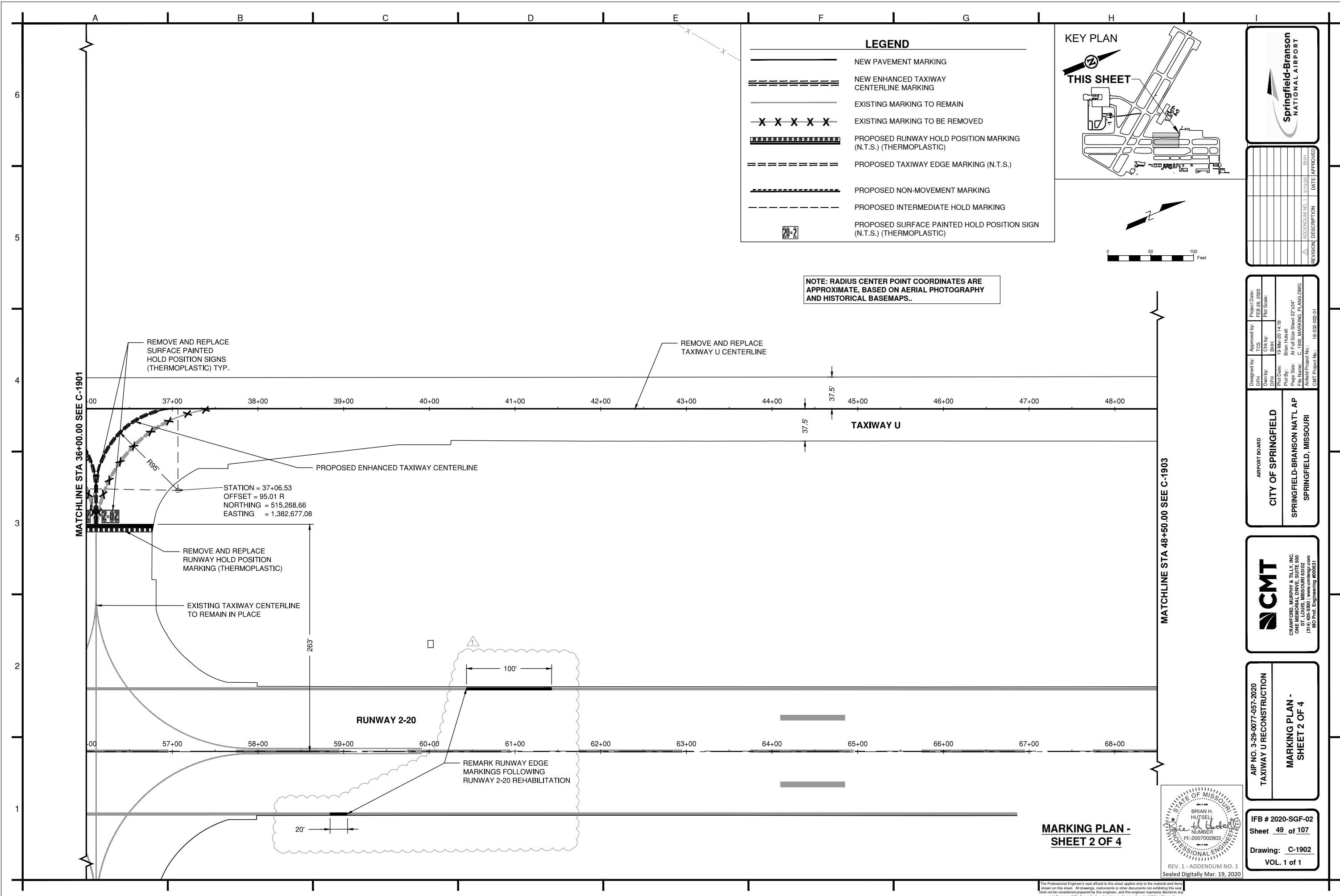

**LEGEND**

	NEW PAVEMENT MARKING
	NEW ENHANCED TAXIWAY CENTERLINE MARKING
	EXISTING MARKING TO REMAIN
	EXISTING MARKING TO BE REMOVED
	PROPOSED RUNWAY HOLD POSITION MARKING (N.T.S.) (THERMOPLASTIC)
	PROPOSED TAXIWAY EDGE MARKING (N.T.S.)
	PROPOSED NON-MOVEMENT MARKING
	PROPOSED INTERMEDIATE HOLD MARKING
	PROPOSED SURFACE PAINTED HOLD POSITION SIGN (N.T.S.) (THERMOPLASTIC)

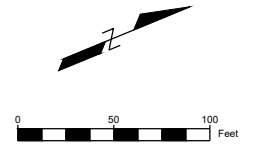
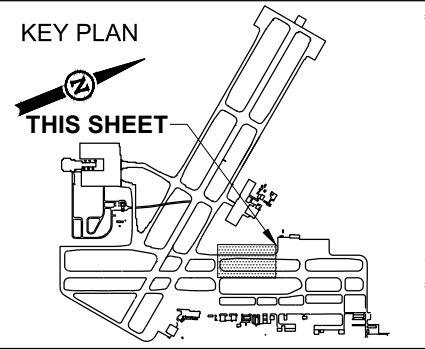

**NOTE: RADIUS CENTER POINT COORDINATES ARE APPROXIMATE, BASED ON AERIAL PHOTOGRAPHY AND HISTORICAL BASEMAPS..**

REMOVE AND REPLACE SURFACE PAINTED HOLD POSITION SIGNS (THERMOPLASTIC) TYP.

REMOVE AND REPLACE TAXIWAY U CENTERLINE

MATCHLINE STA 36+00.00 SEE C-1901

MATCHLINE STA 48+50.00 SEE C-1903

STATION = 37+06.53  
 OFFSET = 95.01 R  
 NORTHING = 515,268.66  
 EASTING = 1,382,677.08

REMOVE AND REPLACE RUNWAY HOLD POSITION MARKING (THERMOPLASTIC)

EXISTING TAXIWAY CENTERLINE TO REMAIN IN PLACE

**RUNWAY 2-20**

REMARK RUNWAY EDGE MARKINGS FOLLOWING RUNWAY 2-20 REHABILITATION

**TAXIWAY U**

**MARKING PLAN - SHEET 2 OF 4**



REVISION	DESCRIPTION	DATE	APPROVED

Designed by:	Approved by:	Project Date:
DH	TCS	FEB 28, 2020
Drawn by:	Checked by:	Plot Scale:
10/20/20	Brian HutSELL	1"=40'
File Name:	File Size:	Plot Size:
C:\1900_MARKING_PLANS.DWG	AT Full Size Sheet 22"x34"	14"x18"
Airfield Project No.:	CMT Project No.:	
	18-032-002-01	

**AIRPORT BOARD**  
**CITY OF SPRINGFIELD**  
 SPRINGFIELD-BRANSON NAT'L AP  
 SPRINGFIELD, MISSOURI









**CMT**  
 CRAWFORD, MURPHY & TILLY, INC.  
 ONE MEMORIAL DRIVE, SUITE 500  
 SPRINGFIELD, MISSOURI 65801  
 (417) 836-5300 | www.cmtinc.com  
 MO Prof. Engineering #006531

**AIP NO. 3-29-0077-057-2020**  
**TAXIWAY U RECONSTRUCTION**  
**MARKING PLAN - SHEET 2 OF 4**

**IFB # 2020-SGF-02**  
 Sheet 49 of 107  
 Drawing: C-1902  
 VOL. 1 of 1

The Professional Engineer's seal affixed to this sheet applies only to the material and items shown on this sheet. All drawings, instruments or other documents not exhibiting this seal shall not be considered prepared by this engineer, and this engineer expressly disclaims any and all responsibility for such plans, drawings or documents not exhibiting this seal.

**LEGEND**

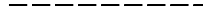
-  NEW PAVEMENT MARKING
-  NEW ENHANCED TAXIWAY CENTERLINE MARKING
-  EXISTING MARKING TO REMAIN
-  EXISTING MARKING TO BE REMOVED
-  PROPOSED RUNWAY HOLD POSITION MARKING (N.T.S.) (THERMOPLASTIC)
-  PROPOSED TAXIWAY EDGE MARKING (N.T.S.)
-  PROPOSED NON-MOVEMENT MARKING
-  PROPOSED INTERMEDIATE HOLD MARKING
-  PROPOSED SURFACE PAINTED HOLD POSITION SIGN (N.T.S.) (THERMOPLASTIC)

**KEY PLAN**

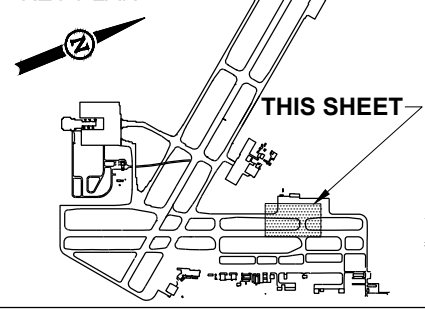

REVISION	DESCRIPTION	DATE	APPROVED

Designed by:	Approved by:	Project Date:
Drawn by:	TCS	FEB 28, 2020
Checked by:	Chk By:	Plot Scale:
Scale:	10" = 20'	14" = 18"
File Name:	At Full Size, Sheet 227-04	File Name:
File Name:	C-1900 MARKING PLANS.DWG	File Name:
Project No.:	18-032-002-01	Project No.:

**AIRPORT BOARD**  
**CITY OF SPRINGFIELD**  
 SPRINGFIELD-BRANSON NAT'L AP  
 SPRINGFIELD, MISSOURI



**AIP NO. 3-29-0077-057-2020**  
**TAXIWAY U RECONSTRUCTION**  
**MARKING PLAN -**  
**SHEET 3 OF 4**

**IFB # 2020-SGF-02**  
**Sheet 50 of 107**  
**Drawing: C-1903**  
**VOL. 1 of 1**



**MARKING PLAN - SHEET 3 OF 4**

MATCHLINE STA 48+50.00 SEE C-1902

MATCHLINE STA 61+00 SEE C-1904

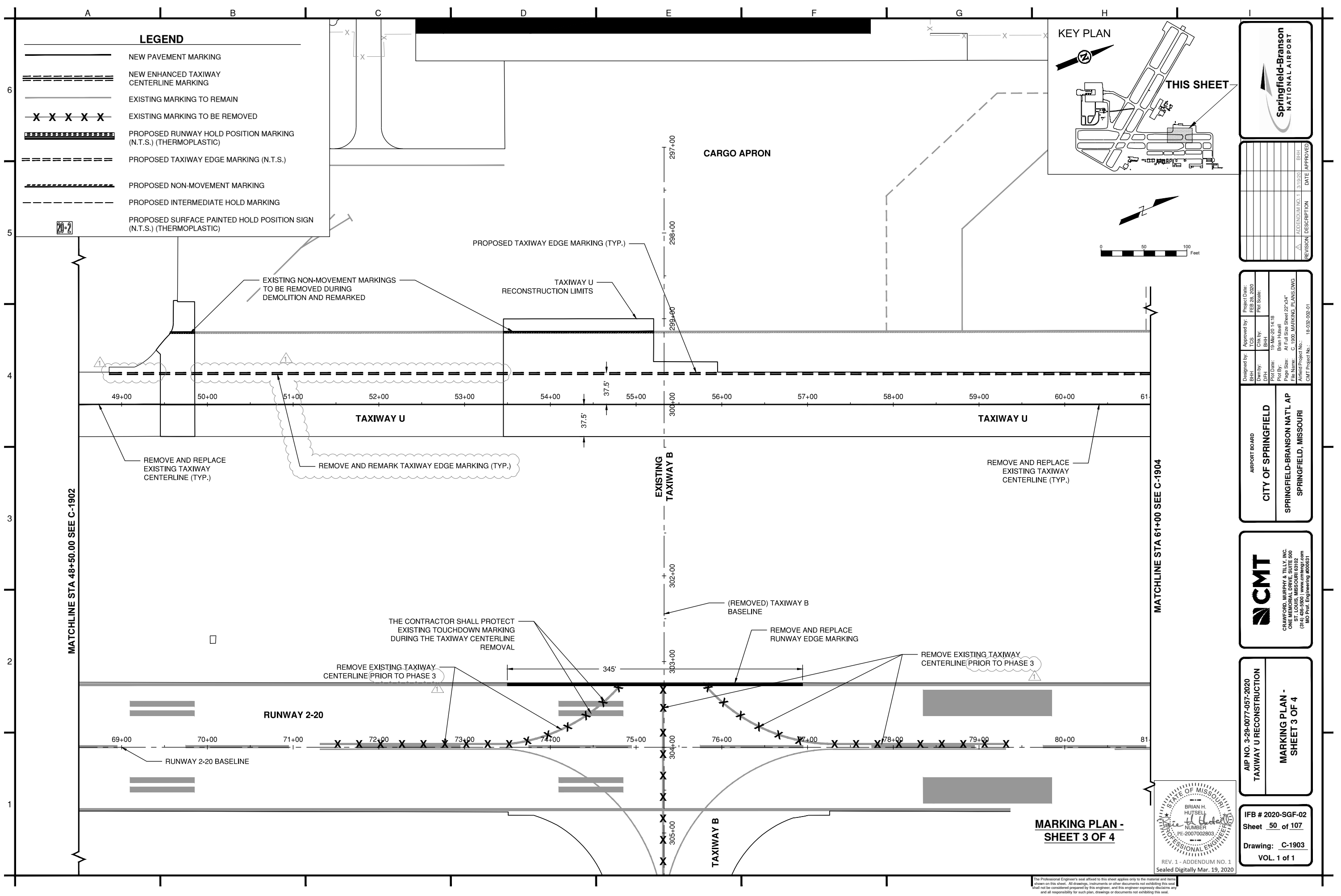

The Professional Engineer's seal affixed to this sheet applies only to the material and items shown on this sheet. All drawings, instruments or other documents not exhibiting this seal shall not be considered prepared by this engineer, and this engineer expressly disclaims any and all responsibility for such plan, drawings or documents not exhibiting this seal.

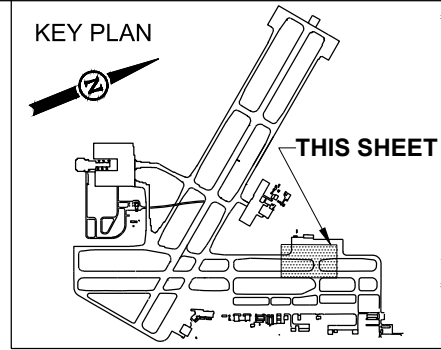
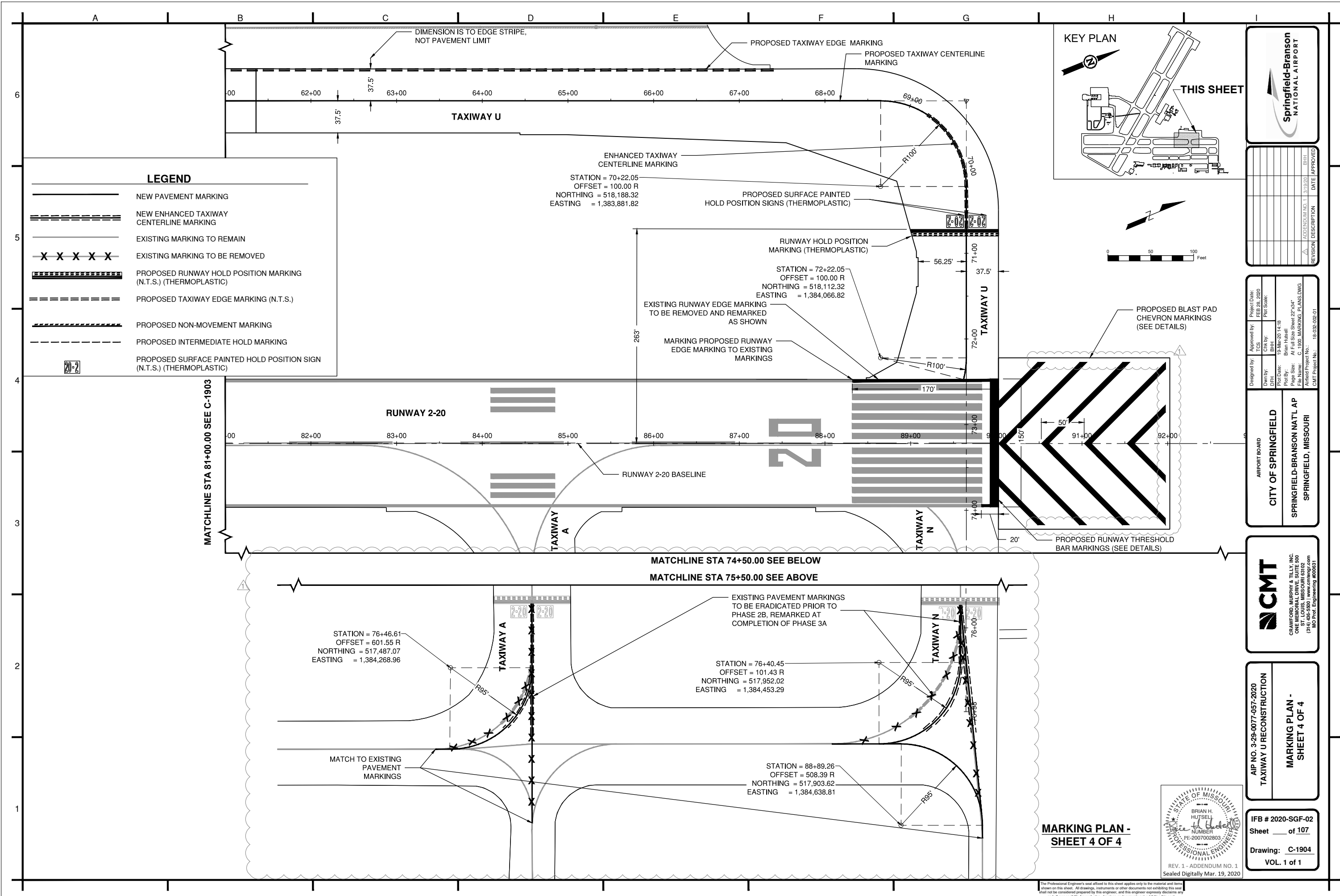

**LEGEND**

- NEW PAVEMENT MARKING
- NEW ENHANCED TAXIWAY CENTERLINE MARKING
- EXISTING MARKING TO REMAIN
- EXISTING MARKING TO BE REMOVED
- PROPOSED RUNWAY HOLD POSITION MARKING (N.T.S.) (THERMOPLASTIC)
- PROPOSED TAXIWAY EDGE MARKING (N.T.S.)
- PROPOSED NON-MOVEMENT MARKING
- PROPOSED INTERMEDIATE HOLD MARKING
- PROPOSED SURFACE PAINTED HOLD POSITION SIGN (N.T.S.) (THERMOPLASTIC)

**Springfield-Branson NATIONAL AIRPORT**

REVISION	DESCRIPTION	DATE	APPROVED

Project Date:	FEB 28, 2020
Approved by:	TCS
Designed by:	CS
Drawn by:	CS
Checked by:	CS
Scale:	AS SHOWN
File Name:	C:\1900_MARKING_PLANS.DWG
Project No.:	18-032-002-01

**AIRPORT BOARD**  
**CITY OF SPRINGFIELD**  
 SPRINGFIELD-BRANSON NAT'L AP  
 SPRINGFIELD, MISSOURI

**CMT**  
 CRAWFORD, MURPHY & TILLY, INC.  
 ONE MEMORIAL DRIVE, SUITE 500  
 SPRINGFIELD, MISSOURI 65801  
 (417) 863-5800 | www.cmtinc.com  
 MO Prof. Engineering #006831

AIP NO. 3-29-0077-057-2020  
 TAXIWAY U RECONSTRUCTION  
 MARKING PLAN -  
 SHEET 4 OF 4

IFB # 2020-SGF-02  
 Sheet \_\_\_\_\_ of 107  
 Drawing: C-1904  
 VOL. 1 of 1

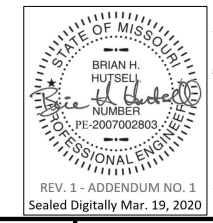

**MARKING PLAN -  
 SHEET 4 OF 4**

The Professional Engineer's seal affixed to this sheet applies only to the material and items shown on this sheet. All drawings, instruments or other documents not exhibiting this seal shall not be considered prepared by this engineer, and this engineer expressly disclaims any and all responsibility for such plans, drawings or documents not exhibiting this seal.